

1:500

A	1	a
B	2	b
C	3	c
D	4	d
E	5	e
F	6	f
G	7	g
H	8	h
I	9	i
L	10	l
M	11	m
N	12	n
O	13	o
P	14	p
Q	15	q
R	16	r
S	17	s
T	18	t
U	19	u
V	20	v
Z	21	z

3BA STUDIOS

Arch. Gianluca Brini
Arch. Luca Pedrazzi

Ing. Gian Franco Gio

Arch. Ing. Nicola Zan

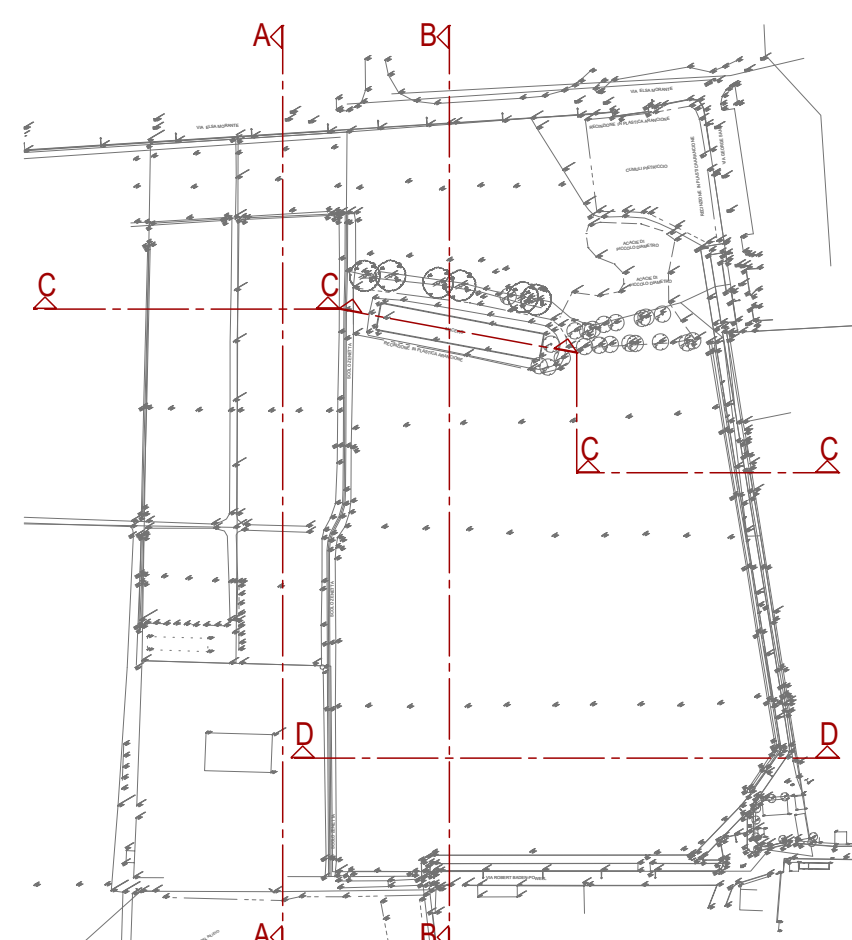

PLANIMETRIA DI RILIEVO
scala 1:2000

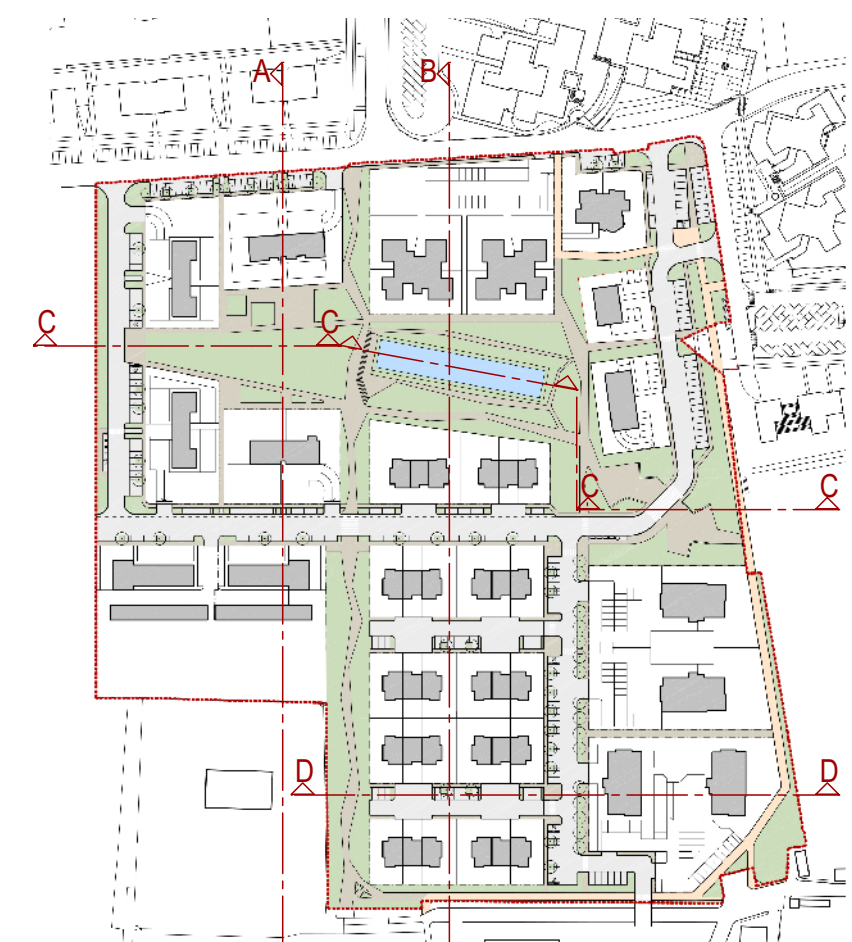

PLANIMETRIA DI PROGETTO
scala 1:2000

This longitudinal section shows the ground profile and proposed road grade along a stretch of approximately 40 meters. The ground surface is represented by a solid black line, while the proposed road grade is shown as a dashed line. Key features include:

- Stationing:** The profile starts at station +45.12 and ends at +45.16.
- Elevation Data:** Elevation points are marked above the ground line: +45.25, +45.78, +45.92, +45.88, +45.54, +45.49, +45.36, +45.36, +45.36, +45.10, +45.05, +45.00, +45.01, and +45.15.
- Topography:** A cluster of trees is depicted between stations +45.54 and +45.49. A single tree is shown at the far left near station +45.12.
- Road Profile:** The dashed line indicates a relatively flat road grade, slightly below the surrounding ground level in most areas.

SEZIONE TRASVERSALE_A-A
scala 1:500

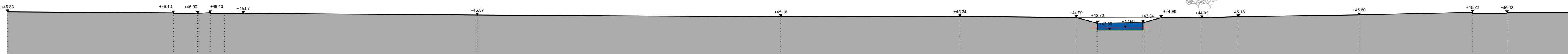

SEZIONE TRASVERSALE_B-E
scala 1:500

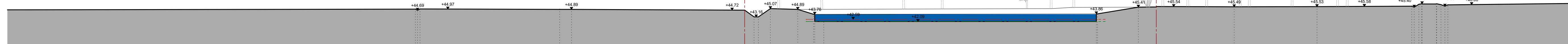

SEZIONE LONGITUDINALE_C-C
scala 1:500

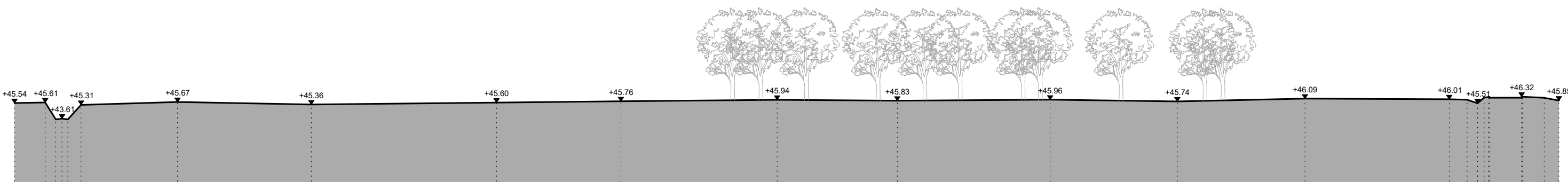

SEZIONE LONGITUDINALE_D-D
scala 1:500

[illegible]

SEZIONE TRASVERSALE_A-A
scala 1:500

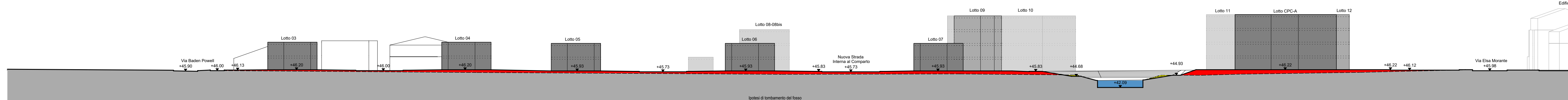

SEZIONE TRASVERSALE_B-E
scala 1:500

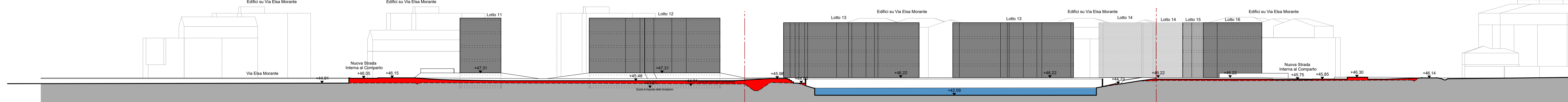

SEZIONE LONGITUDINALE_C-C
scala 1:500

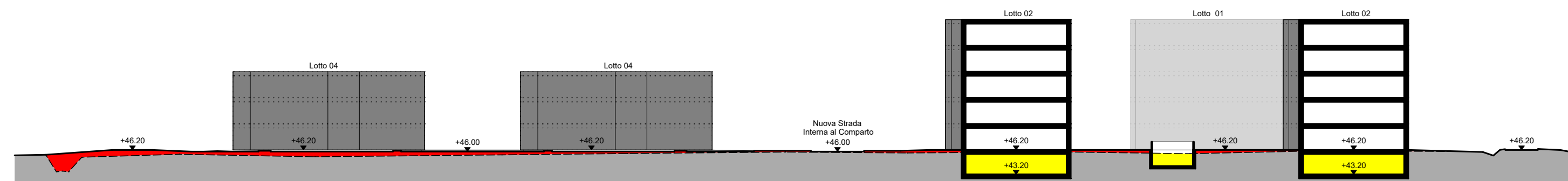

SEZIONE LONGITUDINALE_D-D
scala 1:500

LEGENDA

Profondità rilevata del Macero in punto accessibile

Quota stimata in seguito alla pulizia del fondale

Profilo della sezione di rilievo

Terreno di riporto

Scavo